

## Missing Assembly Notice & Instructions OPW Edge Double Wall Spill Container

### IMPORTANT:

This OPW Edge DW Spill Container was shipped without the Visigaug assembly due to a shortage from our vendor. The product was produced with a temporary plug cap in its place to allow the factory and the installer to perform the interstitial test to verify the integrity of the containment.

We apologize for the inconvenience and OPW will send out a replacement Visigaug to the distributor who purchased this product. It will include a Visigaug assembly and one replacement o-ring seal.

Once you have received the Visigaug, please follow these instructions to install it.

**Step 1:** First, identify the temporary plug cap as the part with the hexagonal shaped head that is installed at the top of the round white gauge riser.

**Step 2:** Please unthread the temporary plug cap from the round white gauge riser.

**Step 3:** Next, install the replacement O-ring onto the underside seat of the Visigaug as shown below.

**Step 4:** Finally, thread on the Visigaug into the white gauge adapter. This should be tightened to a quarter turn past finger tight.

**Step 5:** The Visigaug is now installed and the spill container can be vacuum tested to verify tightness.

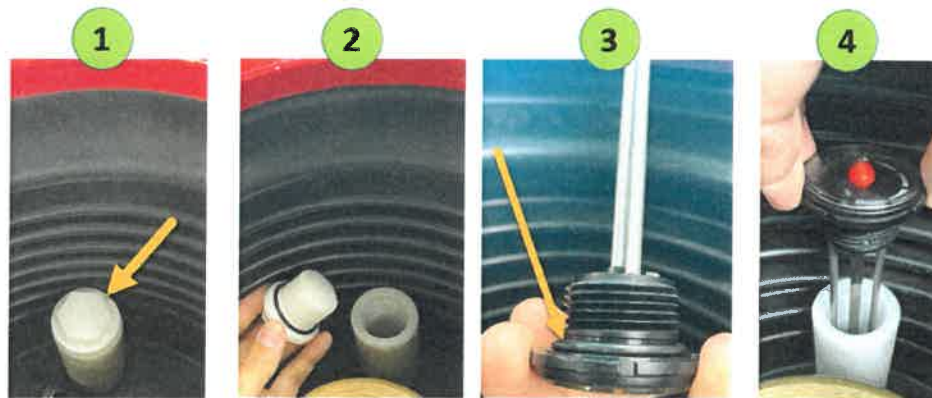

**NOTE; Spill Containers with this plug installed will be identified with the below label beside the OPW part # label on the outside of the box.**

TEMPORARY PLUG INSTALLED  
REPLACE WITH FLOAT WHEN AVAILABLE

CONTACT CUSTOMER SERVICE  
FOR MORE INFORMATION

10:22  
07/23/21

